

Cp.4 Credenzas

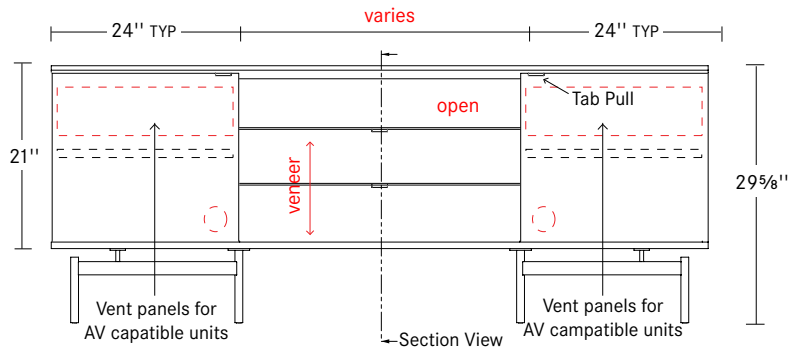

Front View

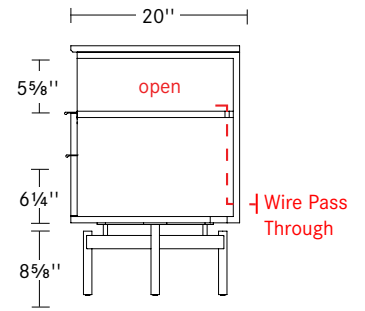

Section View

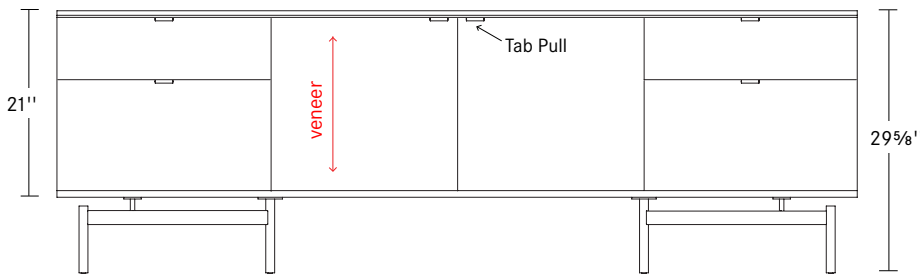

Front View

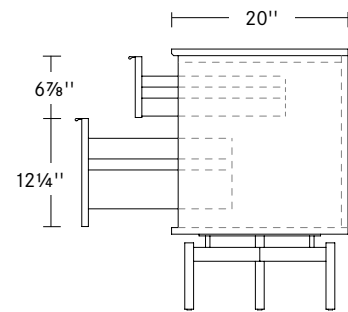

Side View

Trash/Recycling Bin

Slideout, dual compartment trash/recycling bin
 Bin ships assembled
 Includes: (1) open-top 30 liter bin and (1) open-top 19 liter bin
 Overall size: 16 7/8" w x 18 1/4" d x 17 7/8" h, Gray LLDPE
 1" square adhesive backed trash and recycled icons included 
 for optional on-site installation.

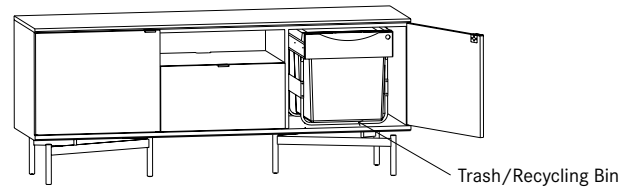

AV Equipment Rack

Rack max weight capacity: 200 lbs.
 Removable AV rack.
 9 usable rack spaces
 Usable Depth: 16"
 Usable Width: 18 1/2"

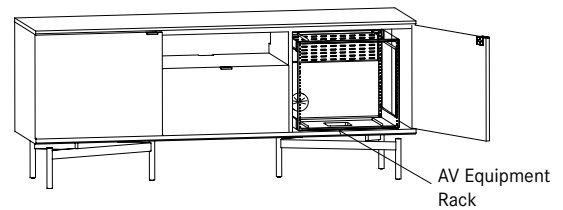

Glass Detail

Bernhardt Design offers a 3/8" thick back-painted glass top for placement on top of any CP.4 credenza. Glass top is offered in etched back-painted white, etched back-painted black and polished back-painted white.

When installing, position the glass top 1/2" from the front and sides, keeping it flush with the back of the credenza.

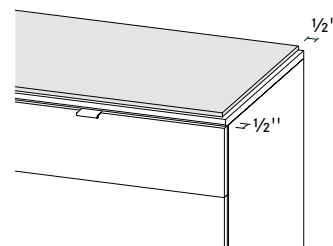

Materials/Finishes

A three character sku identifies each species as well as the standard finish offered. Individual components are priced with standard finish. Special finishes on veneers made to customer specifications are subject to factory approval.

Transparent stains and sealers are applied in multiple steps to enhance the beauty of the natural wood. A durable, baked-on, top-coat of conversion varnish or UV topcoat is applied to protect the product.

It is recommended that felt, cork or fabric backed desk pads and accessories are used on tops to minimize wear. When specifying light finishes such as 836, 837, 840, 850 or 870, the color and characteristic variances of both veneer and solid wood are apparent. Therefore, exact color matches are not possible.

Cp.4 Credenzas are available with vertical veneer inside all the door cabinets and finished backs suitable for open area installations.

Veneer Selections



FL 3/4" Flat Edge

Tops/Pedestals

CHY Cherry

MPL Maple

WLT Walnut

Flat Cut

OAK Oak

PLD Paldao

Rift/Quarter Cut

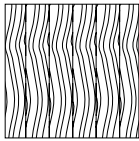
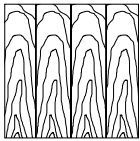

Standard Finishes

CHY Cherry	MPL Maple	WLT Walnut	OAK Oak	PLD Paldao
805	837	823	805	823
834	850	839	836	839
836		841	837	841
839		860	839	860
840		861	840	861
841		866	860	866
861		870	861	870
			865	
			866	
			870	

Glass Selections - Tops

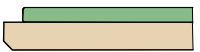

PL 3/8" Polished Flat Edge

GPW Back-Painted White Glass

GEW Etched, Back-Painted White Glass

GEB Etched, Back-Painted Black Glass

Pull/Hardware Selections

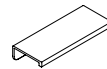

TB Black Tab

TC Chrome Tab

Base Selections

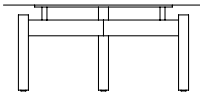

BK Matte Black Powdercoat

SS Polished Stainless Steel

72" credenzas



72" credenzas

includes 3/4" veneer top

						CHY cherry MPL maple OAK oak WLT walnut	PLD paldao
sku	w	d	h	specifications			

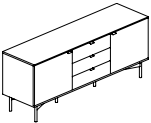

CBN 72 20 29½ (2) 24" w doors with adjustable shelves
(3) 24" w standard storage drawers

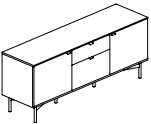

CCN 72 20 29½ (2) 24" w doors with adjustable shelves
(1) 24" w standard storage drawer
(1) 24" w deep storage drawer

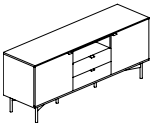

CDN 72 20 29½ (2) 24" w doors with adjustable shelves
(1) 24" w open shelf
(2) 24" w standard storage drawers

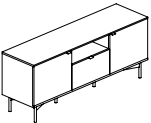

CEN 72 20 29½ (2) 24" w doors with adjustable shelves
(1) 24" w open shelf
(1) 24" w deep storage drawer

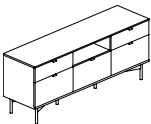

CFN 72 20 29½ (2) 24" w standard storage drawers
(3) 24" w deep storage drawers
(1) 24" w open shelf

specification codes example: C4S-SKU-TB

series	sku	pull
cp.4		TB black tab TC chrome tab
C 4 S -	-	

material/finish code example: BK CHY 805

base finish	material	finish
BK black powdercoat base SS stainless steel base	CHY cherry MPL maple OAK oak WLT walnut PLD paldao	see page 4

72" credenzas



72" credenzas

includes 3/4" veneer top

description	sku	w	d	h	specifications	CHY cherry	PLD paldao
						MPL maple	
						OAK oak	
						WLT walnut	

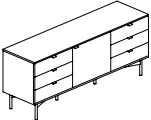

CGN 72 20 29½ (6) 24" w standard storage drawers
(1) 24" w door with adjustable shelf

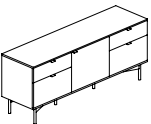

CHN 72 20 29½ (2) 24" w standard storage drawers
(2) 24" w deep storage drawers
(1) 24" w door with adjustable shelf

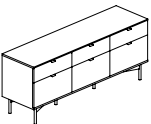

CIN 72 20 29½ (3) 24" w standard storage drawers
(3) 24" w deep storage drawers

specification codes example: C4S-SKU-TB

series	sku	pull
cp.4		TB black tab TC chrome tab
C 4 S -	-	

material/finish code example: BK CHY 805

base finish	material	finish
BK black powdercoat base SS stainless steel base	CHY cherry MPL maple OAK oak WLT walnut PLD paldao	see page 4

72" credenzas with av capability



72" credenzas with av capability

includes 3/4" veneer top, av capability and adjustable self behind each door
 (2) vent panels, gland grommet for cord exit
 removable av rack specified separately, see page 24
 specify av options below

						CHY cherry MPL maple OAK oak WLT walnut	PLD paldao
sku	w	d	h	specifications			

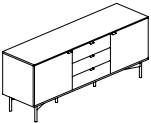

CBT 72 20 29½ (2) 24" w doors with adjustable shelf and av capability
 (3) 24" w standard storage drawers

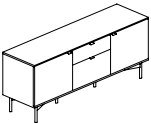

CCT 72 20 29½ (2) 24" w doors with adjustable shelf and av capability
 (1) 24" w standard storage drawer
 (1) 24" w deep storage drawer

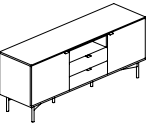

CDT 72 20 29½ (2) 24" w doors with adjustable shelf and av capability
 (1) 24" w open shelf
 (2) 24" w standard storage drawers

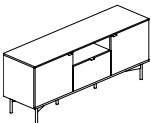

CET 72 20 29½ (2) 24" w doors with adjustable shelf and av capability
 (1) 24" w open shelf
 (1) 24" w deep storage drawer

specification codes example: C4S-SKU-TB

series	sku	pull	av options
cp.4		TB black tab TC chrome tab	VB vents FL fan left upcharge \$350 FR fan right upcharge \$350 FB fan both upcharge \$700
C 4 S -	-		

material/finish code example: BK CHY 805

base finish	material	finish
BK black powdercoat base SS stainless steel base	CHY cherry MPL maple OAK oak WLT walnut PLD paldao	see page 4

84" credenzas



84" credenzas

includes 3/4" veneer top

description	sku	w	d	h	specifications	material/finish code example: BK CHY 805		
						base finish	material	finish
						BK black powdercoat base SS stainless steel base	CHY cherry MPL maple OAK oak WLT walnut PLD paldao	see page 4

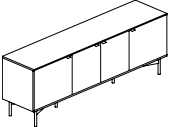

CAL 84 20 29½ (2) 24" w doors with adjustable shelves
(1) 36" w double door with adjustable shelf

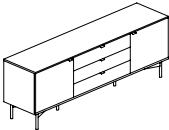

CBL 84 20 29½ (2) 24" w doors with adjustable shelves
(3) 36" w standard storage drawers

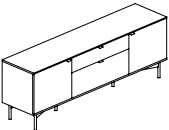

CCL 84 20 29½ (2) 24" w doors with adjustable shelves
(1) 36" w standard storage drawer
(1) 36" w deep storage drawer

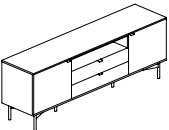

CDL 84 20 29½ (2) 24" w doors with adjustable shelves
(1) 36" w open shelf
(2) 36" w standard storage drawers

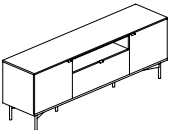

CEL 84 20 29½ (2) 24" w doors with adjustable shelves
(1) 36" w open shelf
(1) 36" w deep storage drawer

specification codes example: C4S-SKU-TB

series	sku	pull
Cp.4		TB black tab TC chrome tab
c 4 S -	-	

material/finish code example: BK CHY 805

base finish	material	finish
BK black powdercoat base SS stainless steel base	CHY cherry MPL maple OAK oak WLT walnut PLD paldao	see page 4

84" credenzas



84" credenzas

includes 3/4" veneer top

	sku	w	d	h	specifications	CHY cherry MPL maple OAK oak WLT walnut	PLD paldao
--	-----	---	---	---	----------------	--	------------

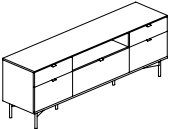

CFL	84	20	29½	(2) 24" w standard storage drawers (2) 24" w deep storage drawers (1) 36" w open shelf (1) 36" w deep storage drawer
-----	----	----	-----	---

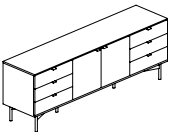

CGL	84	20	29½	(6) 24" w standard storage drawers (1) 36" w double door with adjustable shelf
-----	----	----	-----	---

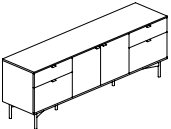

CHL	84	20	29½	(2) 24" w standard storage drawers (2) 24" w deep storage drawers (1) 36" w double door with adjustable shelf
-----	----	----	-----	---

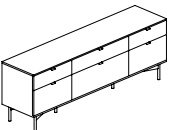

CIL	84	20	29½	(2) 24" w standard storage drawers (2) 24" w deep storage drawers (1) 36" w standard storage drawer (1) 36" w deep storage drawer
-----	----	----	-----	--

specification codes example: C4S-SKU-TB

series	sku	pull
cp.4		TB black tab TC chrome tab
C 4 S -	-	

material/finish code example: BK CHY 805

base finish	material	finish
BK black powdercoat base SS stainless steel base	CHY cherry MPL maple OAK oak WLT walnut PLD paldao	see page 4

84" credenzas with av capability



84" credenzas with av capability

includes ¾" veneer top, av capability and adjustable self behind each door
 (2) vent panels, gland grommet for cord exit
 removable av rack specified separately, see page 24
 specify av options below

CHY	cherry	
MPL	maple	
OAK	oak	
WLT	walnut	
PLD	paldo	

description	sku	w	d	h	specifications
-------------	-----	---	---	---	----------------

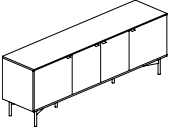

CAU	84	20	29½	(2) 24" w doors with adjustable shelf and av capability (1) 36" w double door with adjustable shelf
-----	----	----	-----	--

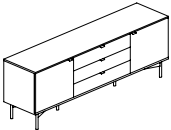

CBU	84	20	29½	(2) 24" w doors with adjustable shelf and av capability (3) 36" w standard storage drawers
-----	----	----	-----	---

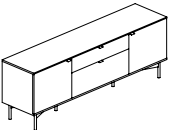

CCU	84	20	29½	(2) 24" w doors with adjustable shelf and av capability (1) 36" w standard storage drawer (1) 36" w deep storage drawer
-----	----	----	-----	---

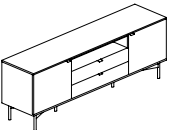

CDU	84	20	29½	(2) 24" w doors with adjustable shelf and av capability (1) 36" w open shelf (2) 36" w standard storage drawers
-----	----	----	-----	---

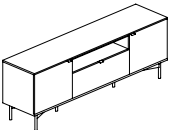

CEU	84	20	29½	(2) 24" w doors with adjustable shelf and av capability (1) 36" w open shelf (1) 36" w deep storage drawer
-----	----	----	-----	--

specification codes example: C4S-SKU-TB

series	sku	pull	av options
cp.4		TB black tab TC chrome tab	VB vents FL fan left upcharge \$350 FR fan right upcharge \$350 FB fan both upcharge \$700
C 4 S -	-		

material/finish code example: BK CHY 805

base finish	material	finish
BK black powdercoat base SS stainless steel base	CHY cherry MPL maple OAK oak WLT walnut PLD paldao	see page 4

90" credenzas



90" credenzas

includes 3/4" veneer top

description	sku	w	d	h	specifications	material	
						CHY cherry	PLD paldao
						MPL maple	
						OAK oak	
						WLT walnut	

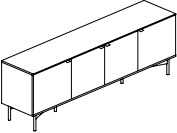

CAK 90 20 29½ (2) 24" w doors with adjustable shelves
 (2) 21" w doors with adjustable shelves

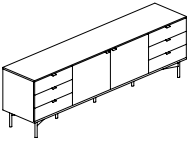

CGK 90 20 29½ (6) 24" w standard storage drawers
 (2) 21" w doors with adjustable shelves

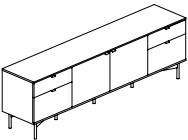

CHK 90 20 29½ (2) 24" w standard storage drawers
 (2) 24" w deep storage drawers
 (2) 21" w doors with adjustable shelves

specification codes example: C4S-SKU-TB

series	sku	pull
cp.4		TB black tab TC chrome tab
C 4 S -	-	

material/finish code example: BK CHY 805

base finish	material	finish
BK black powdercoat base SS stainless steel base	CHY cherry MPL maple OAK oak WLT walnut PLD paldao	see page 4

90" credenzas with av capability



90" credenzas with av capability

includes 3/4" veneer top, av capability and adjustable self behind each door
 (2) vent panels, gland grommet for cord exit
 removable av rack specified separately, see page 24
 specify av options below

description	sku	w	d	h	specifications	CHY	cherry	MPL	maple	OAK	oak	WLT	walnut	PLD	paldo
	CAV	90	20	29½	(2) 24" w doors with adjustable shelf and av capability (2) 21" w doors with adjustable shelves										

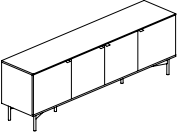

specification codes example: C4S-SKU-TB

series	sku	pull	av options
cp.4		TB black tab TC chrome tab	VB vents FL fan left upcharge \$350 FR fan right upcharge \$350 FB fan both upcharge \$700
C 4 S -	-		

material/finish code example: BK CHY 805

base finish	material	finish
BK black powdercoat base SS stainless steel base	CHY cherry MPL maple OAK oak WLT walnut PLD paldao	see page 4

96" credenzas



96" credenzas

includes 3/4" veneer top

	sku	w	d	h	specifications	CHY cherry MPL maple OAK oak WLT walnut	PLD paldao
--	-----	---	---	---	----------------	--	------------

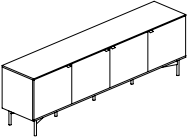

CAJ 96 20 29½ (4) 24" w doors with adjustable shelves

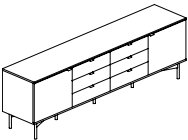

CBJ 96 20 29½ (2) 24" w doors with adjustable shelves
(6) 24" w standard storage drawers

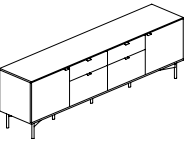

CCJ 96 20 29½ (2) 24" w doors with adjustable shelves
(2) 24" w standard storage drawers
(2) 24" w deep storage drawers

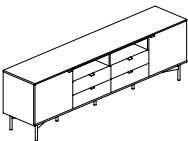

CDJ 96 20 29½ (2) 24" w doors with adjustable shelves
(2) 23 5/8" w open shelves
(4) 24" w standard storage drawers

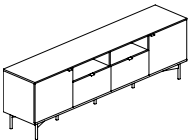

CEJ 96 20 29½ (2) 24" w doors with adjustable shelves
(2) 23 5/8" w open shelves
(2) 24" w deep storage drawers

specification codes example: C4S-SKU-TB

series	sku	pull
cp.4		TB black tab TC chrome tab
C 4 S -	-	

material/finish code example: BK CHY 805

base finish	material	finish
BK black powdercoat base SS stainless steel base	CHY cherry MPL maple OAK oak WLT walnut PLD paldao	see page 4

96" credenzas



96" credenzas

includes 3/4" veneer top

						CHY cherry MPL maple OAK oak WLT walnut	PLD paldao
sku	w	d	h	specifications			

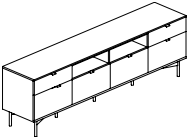

CFJ	96	20	29½	(2) 24" w standard storage drawers (4) 24" w deep storage drawers (2) 23½" w open shelves
-----	----	----	-----	---

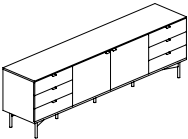

CGJ	96	20	29½	(6) 24" w standard storage drawers (2) 24" w doors with adjustable shelves
-----	----	----	-----	---

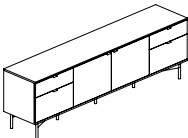

CHJ	96	20	29½	(2) 24" w standard storage drawers (2) 24" w deep storage drawers (2) 24" w doors with adjustable shelves
-----	----	----	-----	---

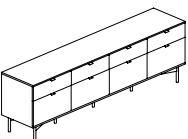

CIJ	96	20	29½	(4) 24" w standard storage drawers (4) 24" w deep storage drawers
-----	----	----	-----	--

specification codes example: C4S-SKU-TB

series	sku	pull
cp.4		TB black tab TC chrome tab
C 4 S -	-	

material/finish code example: BK CHY 805

base finish	material	finish
BK black powdercoat base SS stainless steel base	CHY cherry MPL maple OAK oak WLT walnut PLD paldao	see page 4

96" credenza with av capability



96" credenzas with av capability

includes 3/4" veneer top, av capability and adjustable self behind each door
 (2) vent panels, gland grommet for cord exit
 removable av rack specified separately, see page 24
 specify av options below

CHY	cherry	
MPL	maple	
OAK	oak	
WLT	walnut	
PLD	paldao	

sku	w	d	h	specifications
-----	---	---	---	----------------

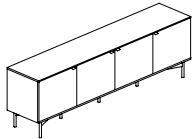

CAW 96 20 29½ (2) 24" w doors with adjustable shelf and av capability
 (2) 24" w doors with adjustable shelves

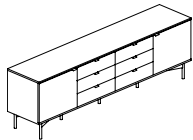

CBW 96 20 29½ (2) 24" w doors with adjustable shelf and av capability
 (6) 24" w standard storage drawers

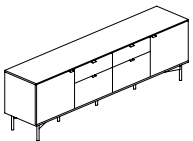

CCW 96 20 29½ (2) 24" w doors with adjustable shelf and av capability
 (2) 24" w standard storage drawers
 (2) 24" w deep storage drawers

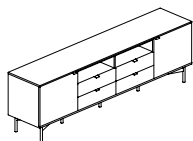

CDW 96 20 29½ (2) 24" w doors with adjustable shelf and av capability
 (2) 23 5/8" w open shelves
 (4) 24" w standard storage drawers

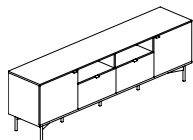

CEW 96 20 29½ (2) 24" w doors with adjustable shelf and av capability
 (2) 23 5/8" w open shelves
 (2) 24" w deep storage drawers

specification codes example: C4S-SKU-TB

series	sku	pull	av options
cp.4		TB black tab TC chrome tab	VB vents FL fan left upcharge \$350 FR fan right upcharge \$350 FB fan both upcharge \$700
C 4 S -	-		

material/finish code example: BK CHY 805

base finish	material	finish
BK black powdercoat base SS stainless steel base	CHY cherry MPL maple OAK oak WLT walnut PLD paldao	see page 4

108" credenzas



108" credenzas

includes 3/4" veneer top

sku	w	d	h	specifications	CHY cherry MPL maple OAK oak WLT walnut	PLD paldao
-----	---	---	---	----------------	--	------------

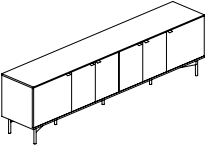

CAH 108 20 29½ (2) 24" w doors with adjustable shelves
(2) 30" w double doors with adjustable shelves

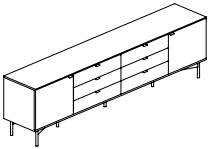

CBH 108 20 29½ (2) 24" w doors with adjustable shelves
(6) 30" w standard storage drawers

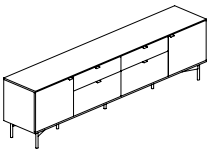

CCH 108 20 29½ (2) 24" w doors with adjustable shelves
(2) 30" w standard storage drawers
(2) 30" w deep storage drawers

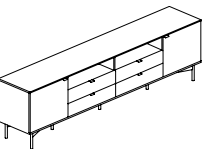

CDH 108 20 29½ (2) 24" w doors with adjustable shelves
(2) 29 5/8" w open shelves
(4) 30" w standard storage drawers

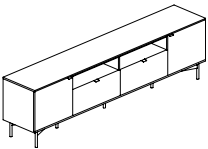

CEH 108 20 29½ (2) 24" w doors with adjustable shelves
(2) 29 5/8" w open shelves
(2) 30" w deep storage drawers

specification codes example: C4S-SKU-TB

series	sku	pull
cp.4		TB black tab TC chrome tab
C 4 S -	-	

material/finish code example: BK CHY 805

base finish	material	finish
BK black powdercoat base SS stainless steel base	CHY cherry MPL maple OAK oak WLT walnut PLD paldao	see page 4

108" credenzas



108" credenzas

includes 3/4" veneer top

	sku	w	d	h	specifications	CHY cherry MPL maple OAK oak WLT walnut	PLD paldao
--	-----	---	---	---	----------------	--	------------

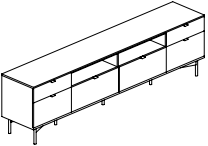

CFH	108	20	29½	(2) 24" w standard storage drawers (2) 24" w deep storage drawers (2) 29½" w open shelves (2) 30" w deep storage drawers
-----	-----	----	-----	---

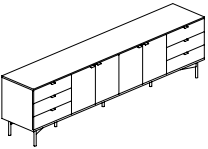

CGH	108	20	29½	(6) 24" w standard storage drawers (2) 30" w double doors with adjustable shelves
-----	-----	----	-----	--

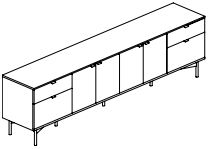

CHH	108	20	29½	(2) 24" w standard storage drawers (2) 24" w deep storage drawers (2) 30" w double doors with adjustable shelves
-----	-----	----	-----	--

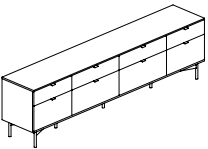

CIH	108	20	29½	(2) 24" w standard storage drawers (2) 24" w deep storage drawers (2) 30" w standard storage drawers (2) 30" w deep storage drawers
-----	-----	----	-----	--

specification codes example: C4S-SKU-TB

series	sku	pull
cp.4		TB black tab TC chrome tab
C 4 S -	-	

material/finish code example: BK CHY 805

base finish	material	finish
BK black powdercoat base SS stainless steel base	CHY cherry MPL maple OAK oak WLT walnut PLD paldao	see page 4

108" credenzas with av capability



108" credenzas with av capability

includes 3/4" veneer top, av capability and adjustable self behind each door
 (2) vent panels, gland grommet for cord exit
 removable av rack specified separately, see page 24
 specify av options below

CHY	cherry	
MPL	maple	
OAK	oak	
WLT	walnut	PLD paldao

sku	w	d	h	specifications
-----	---	---	---	----------------

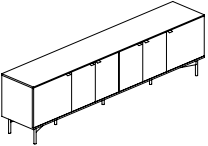

CAX 108 20 29½ (2) 24" w doors with adjustable shelf and av capability
 (2) 30" w double doors with adjustable shelves

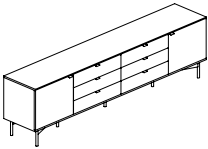

CBX 108 20 29½ (2) 24" w doors with adjustable shelf and av capability
 (6) 30" w standard storage drawers

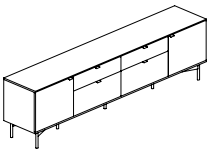

CCX 108 20 29½ (2) 24" w doors with adjustable shelf and av capability
 (2) 30" w standard storage drawers
 (2) 30" w deep storage drawers

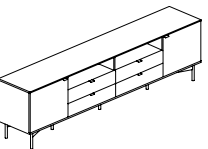

CDX 108 20 29½ (2) 24" w doors with adjustable shelf and av capability
 (2) 29 5/8" w open shelves
 (4) 30" w standard storage drawers

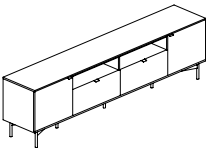

CEX 108 20 29½ (2) 24" w doors with adjustable shelf and av capability
 (2) 29 5/8" w open shelves
 (2) 30" w deep storage drawers

specification codes example: C4S-SKU-TB

series	sku	pull	av options
cp.4		TB black tab TC chrome tab	VB vents FL fan left upcharge \$350 FR fan right upcharge \$350 FB fan both upcharge \$700
C 4 S -	-		

material/finish code example: BK CHY 805

base finish	material	finish
BK black powdercoat base SS stainless steel base	CHY cherry MPL maple OAK oak WLT walnut PLD paldao	see page 4

120" credenzas



120" credenzas

includes 3/4" veneer top

	sku	w	d	h	specifications	CHY cherry MPL maple OAK oak WLT walnut PLD paldao
--	-----	---	---	---	----------------	--

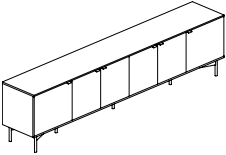

CAF 120 20 29½ (2) 24" w doors with adjustable shelves
 (2) 36" w double doors with adjustable shelves

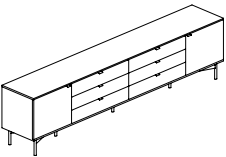

CBF 120 20 29½ (2) 24" w doors with adjustable shelves
 (6) 36" w standard storage drawers

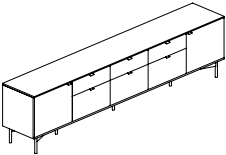

CCF 120 20 29½ (2) 24" w doors with adjustable shelves
 (3) 24" w standard storage drawers
 (3) 24" w deep storage drawers

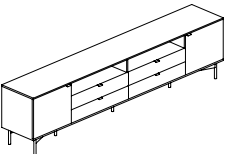

CDF 120 20 29½ (2) 24" w doors with adjustable shelves
 (2) 35½" w open shelves
 (4) 36" w standard storage drawers

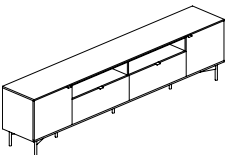

CEF 120 20 29½ (2) 24" w doors with adjustable shelves
 (2) 35½" w open shelves
 (2) 36" w deep storage drawers

specification codes example: C4S-SKU-TB

series	sku	pull
cp.4		TB black tab TC chrome tab
C 4 S -	-	

material/finish code example: BK CHY 805

base finish	material	finish
BK black powdercoat base SS stainless steel base	CHY cherry MPL maple OAK oak WLT walnut PLD paldao	see page 4

120" credenzas



120" credenzas

includes 3/4" veneer top

	sku	w	d	h	specifications	CHY cherry MPL maple OAK oak WLT walnut	PLD paldao
--	-----	---	---	---	----------------	--	------------

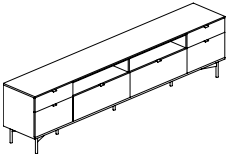

CFF	120	20	29½	(2) 24" w standard storage drawers (2) 24" w deep storage drawers (2) 35⅝" w open shelves (2) 36" w deep storage drawers
-----	-----	----	-----	---

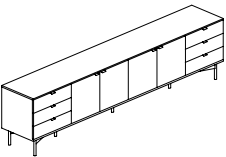

CGF	120	20	29½	(6) 24" w standard storage drawers (2) 36" w double doors with adjustable shelves
-----	-----	----	-----	--

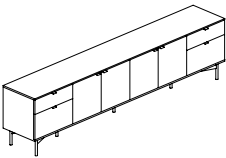

CHF	120	20	29½	(2) 24" w standard storage drawers (2) 24" w deep storage drawers (2) 36" w double doors with adjustable shelves
-----	-----	----	-----	--

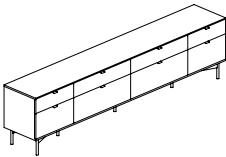

CIF	120	20	29½	(2) 24" w standard storage drawers (2) 24" w deep storage drawers (2) 36" w standard storage drawers (2) 36" w deep storage drawers
-----	-----	----	-----	--

specification codes example: C4S-SKU-TB

series	sku	pull
cp.4		TB black tab TC chrome tab
C 4 S -	-	

material/finish code example: BK CHY 805

base finish	material	finish
BK black powdercoat base SS stainless steel base	CHY cherry MPL maple OAK oak WLT walnut PLD paldao	see page 4

120" credenzas with av capability



120" credenzas with av capability

includes ¾" veneer top, av capability and adjustable self behind each door
 (2) vent panels, gland grommet for cord exit
 removable av rack specified separately, see page 24
 specify av options below

	sku	w	d	h	specifications	CHY cherry MPL maple OAK oak WLT walnut	PLD paldao
--	-----	---	---	---	----------------	--	------------

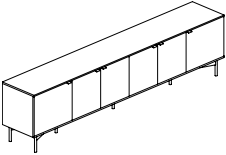

CAY 120 20 29½ (2) 24" w doors with adjustable shelf and av capability
 (2) 36" w double doors with adjustable shelves

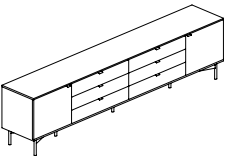

CBY 120 20 29½ (2) 24" w doors with adjustable shelf and av capability
 (6) 36" w standard storage drawers

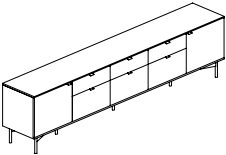

CCY 120 20 29½ (2) 24" w doors with adjustable shelf and av capability
 (3) 24" w standard storage drawers
 (3) 24" w deep storage drawers

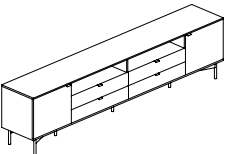

CDY 120 20 29½ (2) 24" w doors with adjustable shelf and av capability
 (2) 35½" w open shelves
 (4) 36" w standard storage drawers

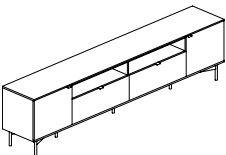

CEY 120 20 29½ (2) 24" w doors with adjustable shelf and av capability
 (2) 35½" w open shelves
 (2) 36" w deep storage drawers

specification codes example: C4S-SKU-TB

series	sku	pull	av options
cp.4		TB black tab TC chrome tab	VB vents FL fan left upcharge \$350 FR fan right upcharge \$350 FB fan both upcharge \$700
C 4 S -	-		

material/finish code example: BK CHY 805

base finish	material	finish
BK black powdercoat base SS stainless steel base	CHY cherry MPL maple OAK oak WLT walnut PLD paldao	see page 4

tops - glass

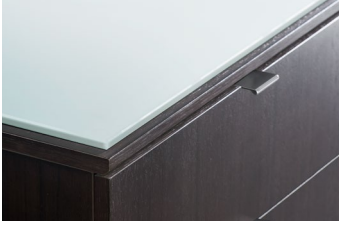

tops - glass

position the glass top 1/2" from front and sides keeping it flush with the back of the credenza
 glass will rest on the surface of the credenza wood top

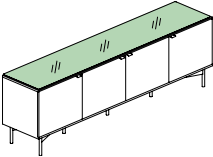

	sku	w	d	h	specifications	GPW back-painted white glass	GEW etched back-painted white glass	GEB etched back-painted black glass
	GLN	71	19½	¾	use with 72" credenza			
	GLL	83	19½	¾	use with 84" credenza			
	GLK	89	19½	¾	use with 90" credenza			
	GLJ	95	19½	¾	use with 96" credenza			
	GLH	107	19½	¾	use with 108" credenza			
	GLF	119	19½	¾	use with 120" credenza			

specification codes example: C4S-SKU

series	sku
cp.4	
C 4 S -	

material/finish code example: PS GPW

edge	material
PF polished flat	GPW back-painted white glass GEW etched back-painted white glass GEB etched back-painted black glass



trash/recycling bin

description	sku	w	d	h
-------------	-----	---	---	---

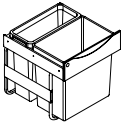

trash/recycling bin T30 16⁷/₈ 18¹/₄ 17⁷/₈

Slideout, dual compartment trash/recycling bin
 Rack ships assembled
 Includes: (1) open-top 30 liter bin and (1) open-top 19 liter bin
 Gray LLDPE
 1" square adhesive backed trash and recycled icons
 included for optional on-site installation.



specification codes example: ACS-SKU

series	sku
cp.4	
C 4 S -	

description	sku	w	d	h
-------------	-----	---	---	---

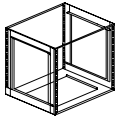

av equipment rack VCU 19 1/4 16 16 5/8

use with av credenzas
 rack max weight capacity: 200 lb.
 field assembled and installed
 specify separately the ACS-VSJ av shelf

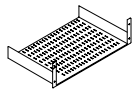

av shelf VSJ 19 15 3/8 3 1/2

mounts to rack rails
 slots for securing components with straps
 hardware included
 usable depth: 15 1/2"
 usable width: 18 1/2"
 specify separately the ACS-VCU equipment rack

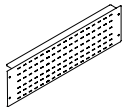

vent panel VP1 19 2 5 1/4

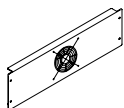

fan FN2 19 2 5 1/4

QFAN
 fan output: 50 CFM
 115V
 <30dBA



wire clip kit WMP 1 5/8 7/8 1 1/2

(5) 1/2" cable clamps
 (5) 1/2" large cable holders
 hardware included

specification codes example: ACS-SKU

series	sku
A C S -	