

**Network Credenzas**

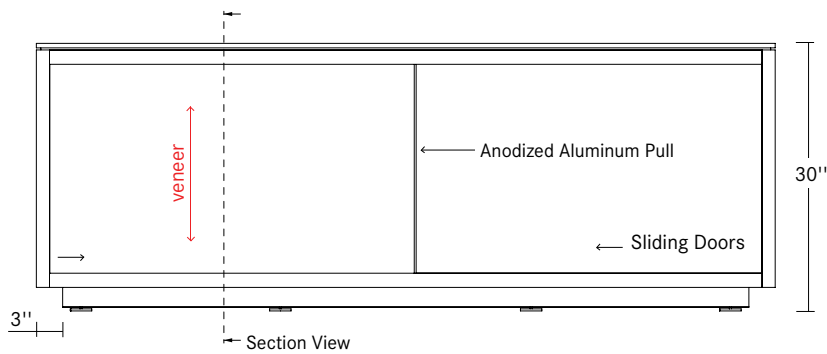

**Front View/Standard Height**

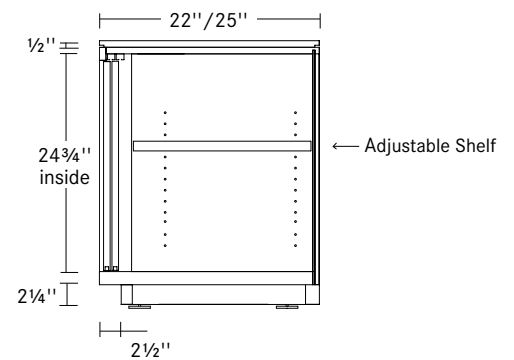

**Section View/Standard Height**

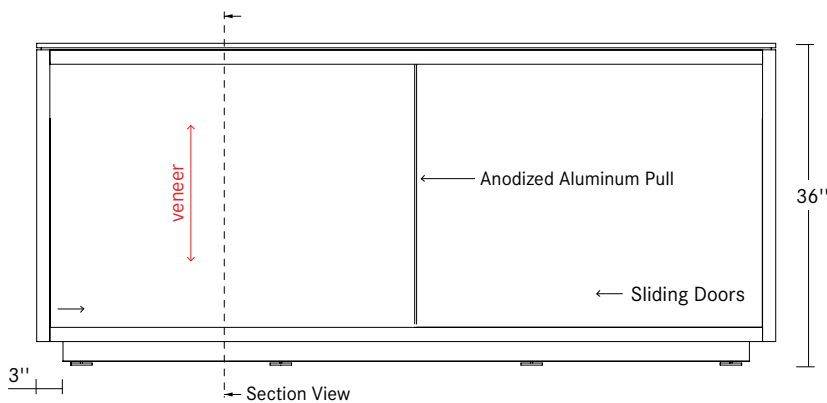

**Front View/Serving Height**

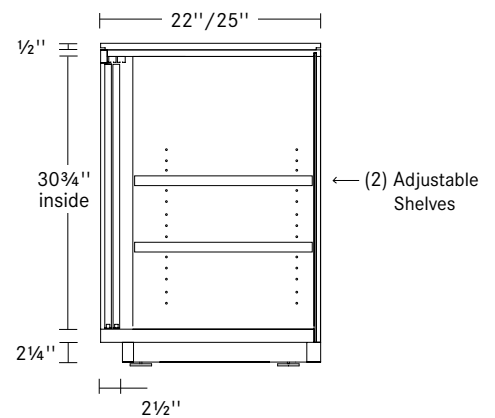

**Section View/Serving Height**

**AV/Refrigerator Credenza**

The Network av/refrigerator credenzas are designed to accommodate refrigeration needs and audiovisual equipment use and storage. Each av/refrigerator credenza comes standard with a vented, thermal sensor cooling fan installed. AV rotating/slideout equipment racks are available for installation, allowing for more flexibility and usage of space. **Refrigerators are not available for purchase from Bernhardt Design and must be purchased separately.**

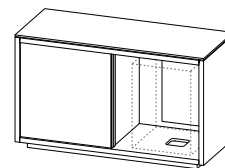

**Front View**  
AV/Refrigerator Credenza

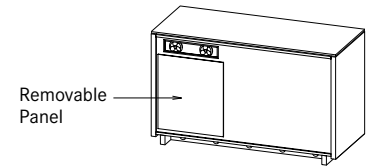

**Back View**  
Showing Removeable Back Panel

**AV Rotating/Slideout Equipment Rack**

Rack max weight capacity: 200 lbs.  
 Rail System: 19" overall depth, 38" extended  
 AV rack must be screwed to the bottom of the case when installed.

**Standard Height:**  
 12 usable rack spaces  
 Usable Depth: 15 1/2"  
 Usable Width: 18 1/2"

**Serving Height:**  
 14 usable rack spaces  
 Usable Depth: 15 1/2"  
 Usable Width: 18 1/2"

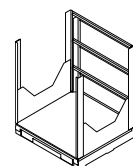

**Front View**  
AV Rotating/Slideout Equipment Rack

**Veneers**

**Veneer Selections**



**FL** 1/2" Flat Edge

A three character sku identifies each species as well as the standard finish offered. Individual components are priced with standard finish. Special finishes on veneers made to customer specifications are subject to factory approval and a 5% net upcharge with a \$500 net minimum.

Transparent stains and sealers are applied in multiple steps to enhance the beauty of the natural wood. A durable, baked-on, top-coat of conversion varnish or UV topcoat is applied to protect the product. It is recommended that felt, cork or fabric backed desk pads and accessories are used on tops to minimize wear.

When specifying light finishes such as 836, 837, 840, 850 or 870, the color and characteristic variances of both veneer and solid wood are apparent. Therefore, exact color matches are not possible.

**Tops/Credenzas**

**CHY** Cherry

**MPL** Maple

**WLT** Walnut

**OAK** Oak

Flat Cut

Rift

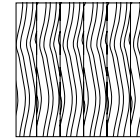
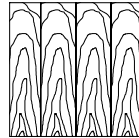

**Standard Finishes**

**CHY** Cherry

**MPL** Maple

**WLT** Walnut

**OAK** Oak

805

837

823

805 865

834

850

839

836 866

836

841

837 870

839

860

839

840

861

840

841

866

860

861

870

861

**Glass Selections - Tops**



**PL** 1/2" Polished Flat Edge

**GPW** Back-Painted White Glass - Top

**GEW** Etched, Back-Painted White Glass - Top

**Solid Surface Selections - Tops**



**FL** 1/4" Flat Edge

**SSF** Solid Surface

**Standard Finish**

**CGW** Corian, Glacier White

**Pull/Hardware Selections**

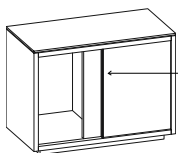

Aluminum Pull

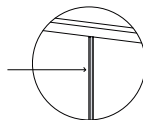

**ST** Tab

**Ordering Guide/Product Selection Sequence**

1. Select credenza depth
2. Select credenza type: assembly or credenza
3. Select standard or serving height
4. Select top material if credenza is specified
5. Select any required accessories

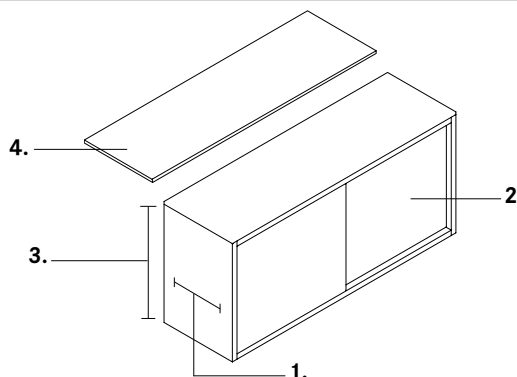

**storage credenzas assemblies 22''d**



**storage credenzas assemblies 22''d**

includes 22''d, 1/2''h veneer top

CHY cherry  
MPL maple  
OAK oak  
WLT walnut

description	sku	w	d	h	specifications
-------------	-----	---	---	---	----------------

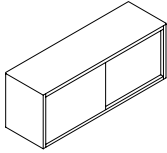

**standard height credenza**

2 sliding doors  
1 polished aluminum pull  
1 adjustable shelf

CLA	48	22	30	no locks
CLB	54	22	30	no locks
CLC	60	22	30	no locks
CLD	66	22	30	no locks
CLE	72	22	30	no locks
CLF	78	22	30	no locks
CLG	84	22	30	no locks
CLH	90	22	30	no locks
CLI	96	22	30	no locks
CLJ	102	22	30	no locks
CLK	108	22	30	no locks

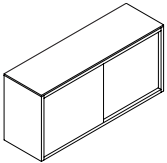

**serving height credenza**

2 sliding doors  
1 polished aluminum pull  
1 adjustable shelf

CHA	48	22	36	no locks
CHB	54	22	36	no locks
CHC	60	22	36	no locks
CHD	66	22	36	no locks
CHE	72	22	36	no locks
CHF	78	22	36	no locks
CHG	84	22	36	no locks
CHH	90	22	36	no locks
CHI	96	22	36	no locks
CHJ	102	22	36	no locks
CHK	108	22	36	no locks

specification codes example: CSS-SKU-FL

series	sku	edge
network		FL 1/4'' flat
C   S   S   -	-	F   L

material/finish code example: WLT 839

material	finish
CHY cherry	see page 4
MPL maple	
OAK oak	
WLT walnut	

storage credenzas 22"d



storage credenzas 22"d

for use with 22"d glass, solid surface or com tops  
specify top separately

CHY	cherry
MPL	maple
OAK	oak
WLT	walnut

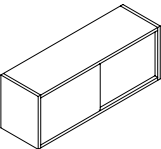
description	sku	w	d	h	specifications
 <p><b>standard height credenza</b> 2 sliding doors 1 polished aluminum pull 1 adjustable shelf</p>	HLA	48	22	30	no locks
	HLB	54	22	30	no locks
	HLC	60	22	30	no locks
	HLD	66	22	30	no locks
	HLE	72	22	30	no locks
	HLF	78	22	30	no locks
	HLG	84	22	30	no locks
	HLH	90	22	30	no locks
	HLI	96	22	30	no locks
	HLJ	102	22	30	no locks
	HLK	108	22	30	no locks

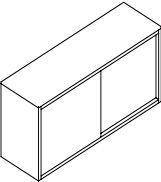
 <p><b>serving height credenza</b> 2 sliding doors 1 polished aluminum pull 2 adjustable shelves</p>	HHA	48	22	36	no locks
	HHB	54	22	36	no locks
	HHC	60	22	36	no locks
	HHD	66	22	36	no locks
	HHE	72	22	36	no locks
	HHF	78	22	36	no locks
	HHG	84	22	36	no locks
	HHH	90	22	36	no locks
	HHI	96	22	36	no locks
	HHJ	102	22	36	no locks
	HHK	108	22	36	no locks

specification codes example: CSS-SKU-00

series	sku	edge
network		00 none
C   S   S   -	-	0   0

material/finish code example: WLT 839

material	finish
CHY cherry	see page 4
MPL maple	
OAK oak	
WLT walnut	

tops - glass/solid surface 22"d

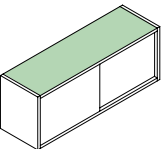

tops - glass/solid surface 22"d

description	sku	w	d	h	GPW	GEW etched
					back-painted white glass	back-painted white glass
 <p><b>glass top 22"d</b> 1/2" glass top has veneer edge band subtop construction specify material code GPW or GEW specify subtop code and subtop finish code</p>	GLA	48	22	1/2		
	GLB	54	22	1/2		
	GLC	60	22	1/2		
	GLD	66	22	1/2		
	GLE	72	22	1/2		
	GLF	78	22	1/2		
	GLG	84	22	1/2		
	GLH	90	22	1/2		
	GLI	96	22	1/2		
	GLJ	102	22	1/2		
	GLK	108	22	1/2		

specification codes example: AKS-SKU-PL

series	sku	edge
network		PL 1/4" polished flat
C   S   S   -	-	P   L

material/finish code example: GPW CHT 805

material	subtop	subtop finish
GPW glass back-painted white GEW glass etched back-painted white	PNT paint CHY cherry MPL maple OAK oak	see page 4

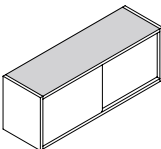
description	sku	w	d	h	SSF solid surface*
 <p><b>solid surface top 22"d</b> 1 1/4" h solid surface top</p>	SFA	48	22	1 1/4	
	SFB	54	22	1 1/4	
	SFC	60	22	1 1/4	
	SFD	66	22	1 1/4	
	SFE	72	22	1 1/4	
	SFF	78	22	1 1/4	
	SFG	84	22	1 1/4	
	SFH	90	22	1 1/4	
	SFI	96	22	1 1/4	
	SFJ	102	22	1 1/4	
	SFK	108	22	1 1/4	

specification codes example: CSS-SKU-FL

series	sku	edge
network		FL 1/4" flat
C   S   S   -	-	F   L

material/finish code example: SSF CGW

material	finish
SSF solid surface	CGW glacier white
S   S   F	C   G   W

av/refrigerator credenzas  
assemblies 25''d



av/refrigerator credenzas assemblies 25''d

includes 25''d, 1¼'' veneer top

CHY	cherry
MPL	maple
OAK	oak
WLT	walnut

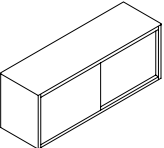
description	sku	w	d	h	specifications
 <p><b>standard height av/refrigerator credenza</b></p> <p>2 sliding doors 1 polished aluminum pull 1 adjustable shelf removable back panel for av/refrigerator</p>	ALA	48	25	30	1 lock
	ALB	54	25	30	1 lock
	ALC	60	25	30	1 lock
	ALD	66	25	30	1 lock
	ALE	72	25	30	1 lock
	ALF	78	25	30	1 lock
	ALG	84	25	30	1 lock
	ALH	90	25	30	1 lock
	ALI	96	25	30	1 lock
	ALJ	102	25	30	1 lock
ALK	108	25	30	1 lock	

Refrigerators are not available for purchase from Bernhardt Design and must be purchased separately

holds 1.5 cubic foot refrigerator  
interior Dimensions: 28½''w x 20½''d x 24¾''h  
specify separately the ACS-VCZ equipment rack

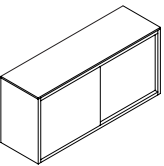

**serving height  
av/refrigerator credenza**

2 sliding doors  
1 polished aluminum pull  
2 adjustable shelves  
removable back panel for av/refrigerator

AHA	48	25	36	1 lock
AHB	54	25	36	1 lock
AHC	60	25	36	1 lock
AHD	66	25	36	1 lock
AHE	72	25	36	1 lock
AHF	78	25	36	1 lock
AHG	84	25	36	1 lock
AHH	90	25	36	1 lock
AHI	96	25	36	1 lock
AHJ	102	25	36	1 lock
AHK	108	25	36	1 lock

Refrigerators are not available for purchase from Bernhardt Design and must be purchased separately

holds 1.7 cubic foot refrigerator  
interior Dimensions: 28½''w x 20½''d x 30¾''h  
specify separately the ACS-VCY equipment rack

specification codes example: CSS-SKU-FL

series	sku	edge
network		FL 1¼'' flat
C   S   S   -	-	F   L

material/finish code example: WLT 839

material	finish
CHY cherry MPL maple OAK oak WLT walnut	see page 4

av/refrigerator credenzas 25"d



av/refrigerator credenzas 25"d

for use with 25"d glass, solid surface or com tops  
specify top separately

description	sku	w	d	h	specifications	material/finish code example: WLT 839	
						material	finish
						CHY cherry	see page 4
						MPL maple	
						OAK oak	
						WLT walnut	

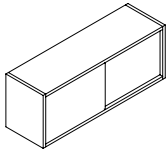

**standard height**  
av/refrigerator credenza

- 2 sliding doors
- 1 polished aluminum pull
- 1 adjustable shelf
- removable back panel for av/refrigerator

sku	w	d	h	specifications
KLA	48	25	30	1 lock
KLB	54	25	30	1 lock
KLC	60	25	30	1 lock
KLD	66	25	30	1 lock
KLE	72	25	30	1 lock
KLF	78	25	30	1 lock
KLG	84	25	30	1 lock
KLH	90	25	30	1 lock
KLI	96	25	30	1 lock
KLJ	102	25	30	1 lock
KLK	108	25	30	1 lock

Refrigerators are not available for purchase from Bernhardt Design and must be purchased separately

holds 1.5 cubic foot refrigerator  
interior Dimensions: 28 1/8"w x 20 1/2"d x 24 3/4"h  
specify separately the ACS-VCZ equipment rack

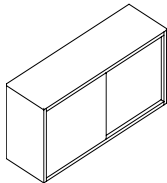

**serving height**  
av/refrigerator credenza

- 2 sliding doors
- 1 polished aluminum pull
- 2 adjustable shelves
- removable back panel for av/refrigerator

sku	w	d	h	specifications
KHA	48	25	36	1 lock
KHB	54	25	36	1 lock
KHC	60	25	36	1 lock
KHD	66	25	36	1 lock
KHE	72	25	36	1 lock
KHF	78	25	36	1 lock
KHG	84	25	36	1 lock
KHH	90	25	36	1 lock
KHI	96	25	36	1 lock
KHJ	102	25	36	1 lock
KHK	108	25	36	1 lock

Refrigerators are not available for purchase from Bernhardt Design and must be purchased separately

holds 1.7 cubic foot refrigerator  
interior Dimensions: 28 1/8"w x 20 1/2"d x 30 3/4"h  
specify separately the ACS-VCY equipment rack

specification codes example: CSS-SKU-00

series	sku	edge
network		00 none
C   S   S   -	-	0   0

material/finish code example: WLT 839

material	finish
CHY cherry	see page 4
MPL maple	
OAK oak	
WLT walnut	

tops - glass/solid surface 25''d



tops - glass/solid surface

for use with 25'' av/refrigerator credenzas

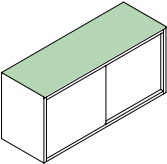
description	sku	w	d	h	GPW	GEW
					back-painted white glass	etched back-painted white glass
 <p><b>glass top 25''d</b></p> <p>1/2'' glass top has veneer edge band subtop construction specify material code GPW or GEW specify subtop and subtop finish code</p>	GHA	48	25	1/2		
	GHB	54	25	1/2		
	GHC	60	25	1/2		
	GHD	66	25	1/2		
	GHE	72	25	1/2		
	GHF	78	25	1/2		
	GHG	84	25	3/4		
	GHH	90	25	3/4		
	GHI	96	25	3/4		

specification codes example: AKS-SKU-PL

series	sku	edge
network		PL 1 1/4'' polished flat
C   S   S   -	-	P   L

material/finish code example: GPW CHT 805

material	subtop	subtop finish
GPW glass back-painted white GEW glass etched back-painted white	PNT paint CHY cherry MPL maple OAK oak	see page 4

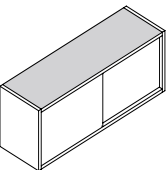
description	sku	w	d	h	SSF solid surface*
 <p><b>solid surface top 25''d</b></p> <p>1 1/4''h solid surface top</p>	SHA	48	25	1 1/4	
	SHB	54	25	1 1/4	
	SHC	60	25	1 1/4	
	SHD	66	25	1 1/4	
	SHE	72	25	1 1/4	
	SHF	78	25	1 1/4	
	SHG	84	25	1 1/4	
	SHH	90	25	1 1/4	
	SHI	96	25	1 1/4	
	SHJ	102	25	1 1/4	
SHK	108	25	1 1/4		

specification codes example: CSS-SKU-FL

series	sku	edge
network		FL 1 1/4'' flat
C   S   S   -	-	F   L

material/finish code example: SSF CGW

material	finish
SSF solid surface	CGW glacier white
S   S   F	C   G   W



av rotating/slideout equipment rack



av rotating/slideout equipment rack

description	sku	w	d	h	specifications
-------------	-----	---	---	---	----------------

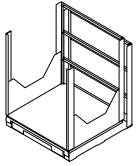

**standard height  
av rotating/slideout equipment rack**

VCZ	19	19-38	24	12 usable rack spaces
-----	----	-------	----	-----------------------

use with 30" h av/refrigerator credenzas  
telescoping depth: 16" - 26"  
rack max weight capacity: 200 lb.  
field assembled and installed  
specify separately the ACS-VCX av shelf

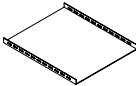

**av shelf**

VCX	19	16¼	1½
-----	----	-----	----

sliding rail system shelf, mounts to rack rails  
slots for securing components with straps  
hardware included  
usable depth: 15½"  
usable width: 18½"  
specify separately the ACS-VCZ equipment rack

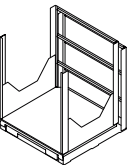

**serving height  
av rotating/slideout equipment rack**

VCY	19	19-38	27½	14 usable rack spaces
-----	----	-------	-----	-----------------------

use with 30" h av/refrigerator credenzas  
telescoping depth: 16" - 26"  
max weight capacity: 200 lb.  
field assembled and installed  
specify separately the ACS-VCX av shelf

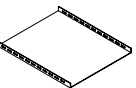

**av shelf**

VCW	18¾	16¼	1½
-----	-----	-----	----

sliding rail system shelf, mounts to rack rails  
slots for securing components with straps  
hardware included  
usable depth: 15½"  
usable width: 18½"  
specify separately the ACS-VCY equipment rack

specification codes example: ACS-SKU

series	sku
accessory	
A   C   S   -	